

EMBASSY

LETTINGS & MANAGEMENT



64 Stonefield, Cambridge, CB23 8TE

£1,300 Per month

Two Bedroom Mid Terrace House situated in the popular village of Bar Hill, providing excellent access to North Cambridge, the City Centre and the A14. The accommodation comprises of;

Entrance hallway, lounge, kitchen, two bedrooms and a bathroom. The property also has a rear garden.

Entrance Hallway
3m x 1.8m with under-stairs storage

Sitting/Dining Room
4m x 3.6m With patio doors to rear garden, laminate wood flooring



Floor Plan

Ground Floor

Approx. 27.5 sq. metres (296.4 sq. feet)

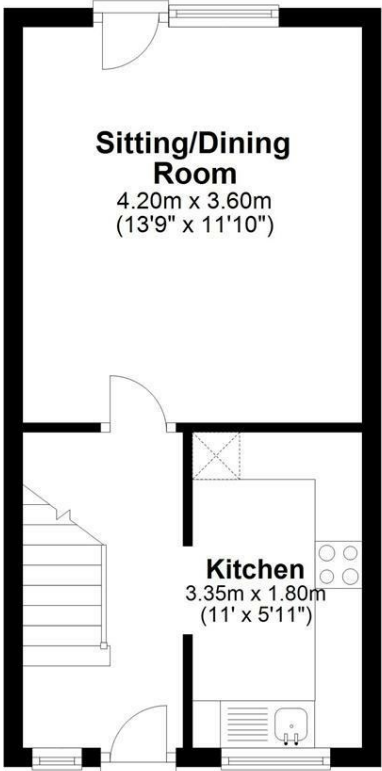

First Floor

Approx. 27.5 sq. metres (296.4 sq. feet)

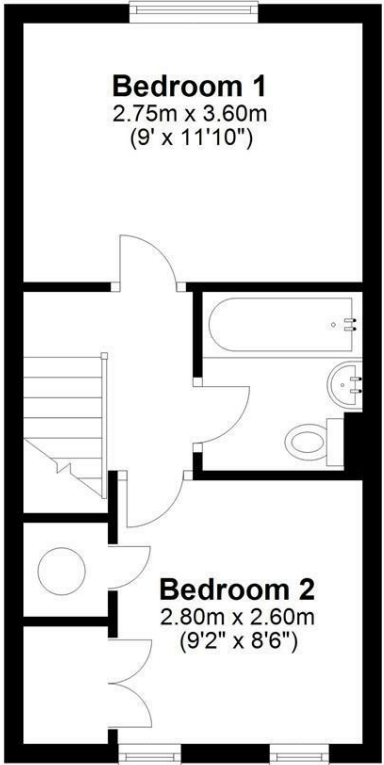

Total area: approx. 55.1 sq. metres (592.9 sq. feet)

Drawings are for guidance only. www.beachenergy.co.uk
Plan produced using PlanUp.

Area Map



Energy Efficiency Graph

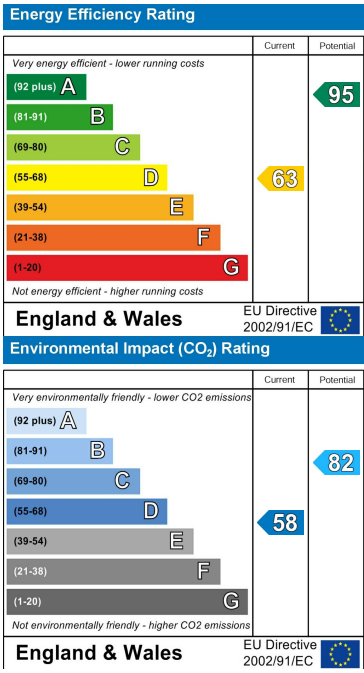

These particulars, whilst believed to be accurate are set out as a general outline only for guidance and do not constitute any part of an offer or contract. Intending purchasers should not rely on them as statements of representation of fact, but must satisfy themselves by inspection or otherwise as to their accuracy. No person in this firms employment has the authority to make or give any representation or warranty in respect of the property.